

REINSTATEMENT REPORT

Plans used: RP51646, RP91916, RP137104, RP137918, IS21803, IS116920, IS119823, IS145831, SP147521, SP147522, SP199916 and SP209227.
 Reinstatement follows previous surveys, with very good agreement.
 Stn's 1, 6, 7, 8, 9a, 10, 12, 13, 19a & 19 fixed by 0 marks in very good agreement.
 Distance 10 - 19 agrees with previous plans.
 This distance measures 11mm excess which was proportioned between Stn's 14 - 19
 A 5" swing has been introduced between King Street and Armstrong Way on previous plans, this amounts to less than 5mm between Matthew Terrace and Beerburum road.
 Line 9-6 has been maintained parallel to Line 10-19 as per original intent.
 Side boundaries maintained square to King Street.

REFERENCE MARKS

STN	TO	ORIGIN	BEARING	DIST
1	O.Nail in conc	5/RP231407	324°57'	3-534
1	O.Screw in conc (New Ref)	2/IS116920	339°58'	3-817
2	Screw in conc		2°08'	4-069
6	Screw in conc		352°29'	1-108
6	O.Nail in kerb	19/SP147521	344°21'	1-725
7	O.Screw in conc	18/SP147521	53°25'	5-72
9	Screw fd in conc		344°31'35"	22-959
9	Screw in conc		343°39'	1-687
10	Screw fd in traffic ls		60°42'	14-825
12	O.Screw in kerb	5/SP209227	168°15'	4-962
13	O.Screw in conc	6/SP209227	182°34'	3-349
13	O.Screw in conc	6/SP209227	173°51'	6-008
15	O.Screw in conc (New Ref)	8/SP199916	101°59'	8-605
16	Screw in conc		164°35'	3-409
17	Screw in conc		285°28'	1-606
19	O.Screw in conc gone	1/SP147521	233°54'	3-66
19	Nail fd in kerb		191°20'	4-359
19	Screw in conc		237°19'	3-288
19	Screw fd in conc		276°29'	2-515

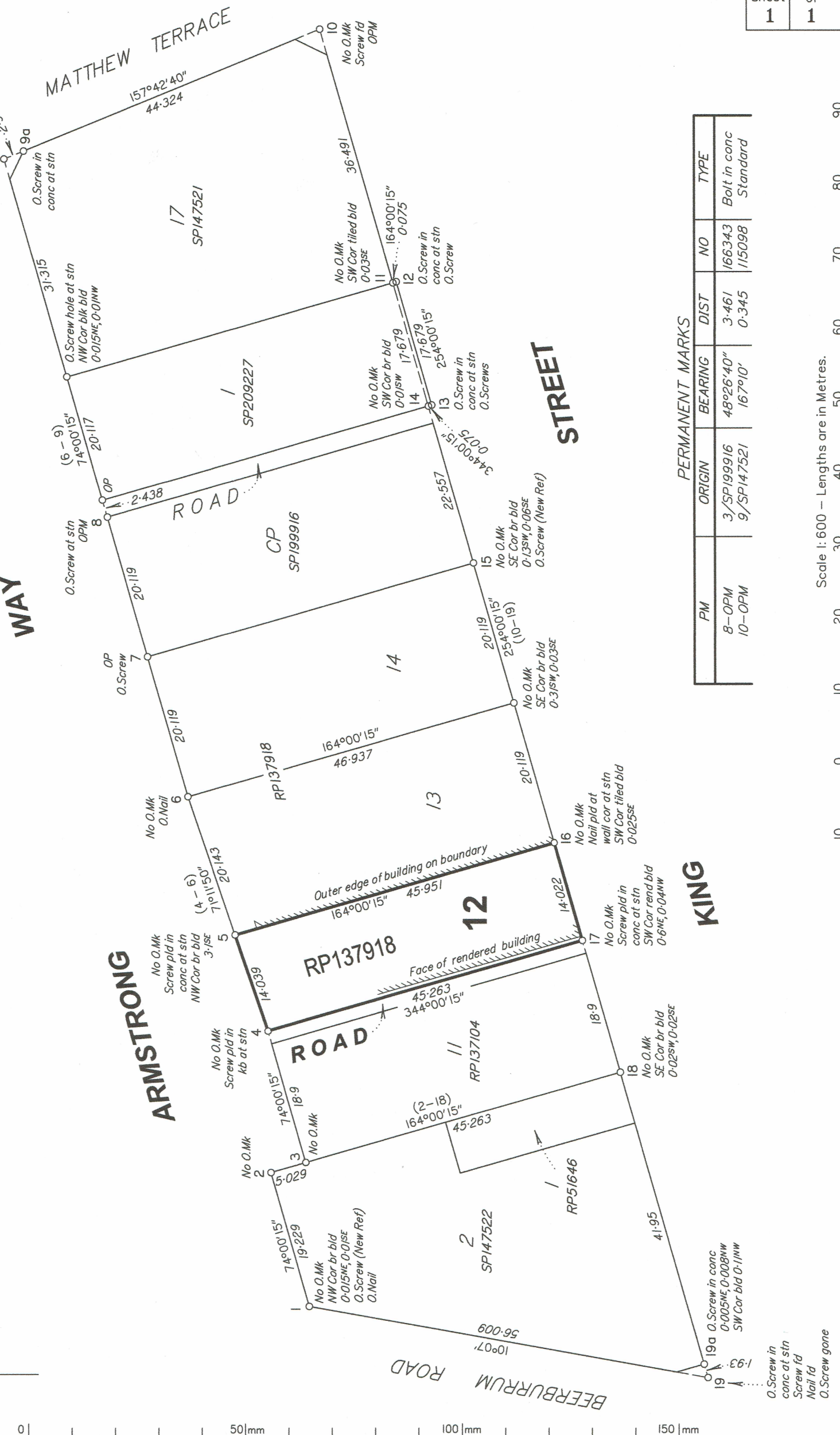
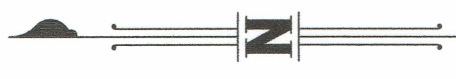

PM	ORIGIN	BEARING	DIST	NO	TYPE
8-OPM	3/SP199916	48°26'40"	3-461	166343	Bolt in conc
10-OPM	9/SP147521	167°10'	0-345	115098	Standard

Scale 1:600 - Lengths are in Metres.

Queensland Surveying Solutions Pty Ltd (ACN 118 589 174) hereby certify that the land comprised in this plan was surveyed by the corporation, by Paul James KROGH, Surveying Graduate, for whose work the corporation accepts responsibility, under the supervision of Stephen John HOLLOWAY, Cadastral Surveyor, and that the plan is accurate, that the said survey was performed in accordance with the Survey and Mapping Infrastructure Act 2003 and Surveyors Act 2003 and associated Regulations and Standards and that the said survey was completed on 22/07/2019.

[Signature]
 Cadastral Surveyor / Director
 Date: 28-8-19

Plan of Identification Survey of Lot 12 on RP137918

LOCAL GOVERNMENT: MORETON BAY REGIONAL	LOCALITY: CABOOLTURE
MERIDIAN: SPI47521	Original Portion: 22
Scale: 1:600	Survey Records: No

QSS QUEENSLAND SURVEYING SOLUTIONS
 Queensland Surveying Solutions Pty Ltd
 ACN 118 589 174
 14-15/640 Albany Creek Rd,
 Albany Creek, QLD, 4035
 t: 07 3325 0927
 f: 07 3325 0927
 e: admin@qssurveying.com.au

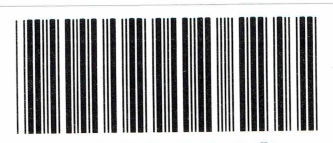

IS286348